

**Tech Rider**

**Workshop-Room**

Contact Partner    Martin Zumbil  
**Engineering**        Victor Malta  
Mailing address    D.-Martin-Luther-Str. 3; 93047 Regensburg  
Telefon                0941/507-2857 /-2859  
E-Mail                 kreativ@regensburg.de

**Ground-plan**

**DEGGINGER**

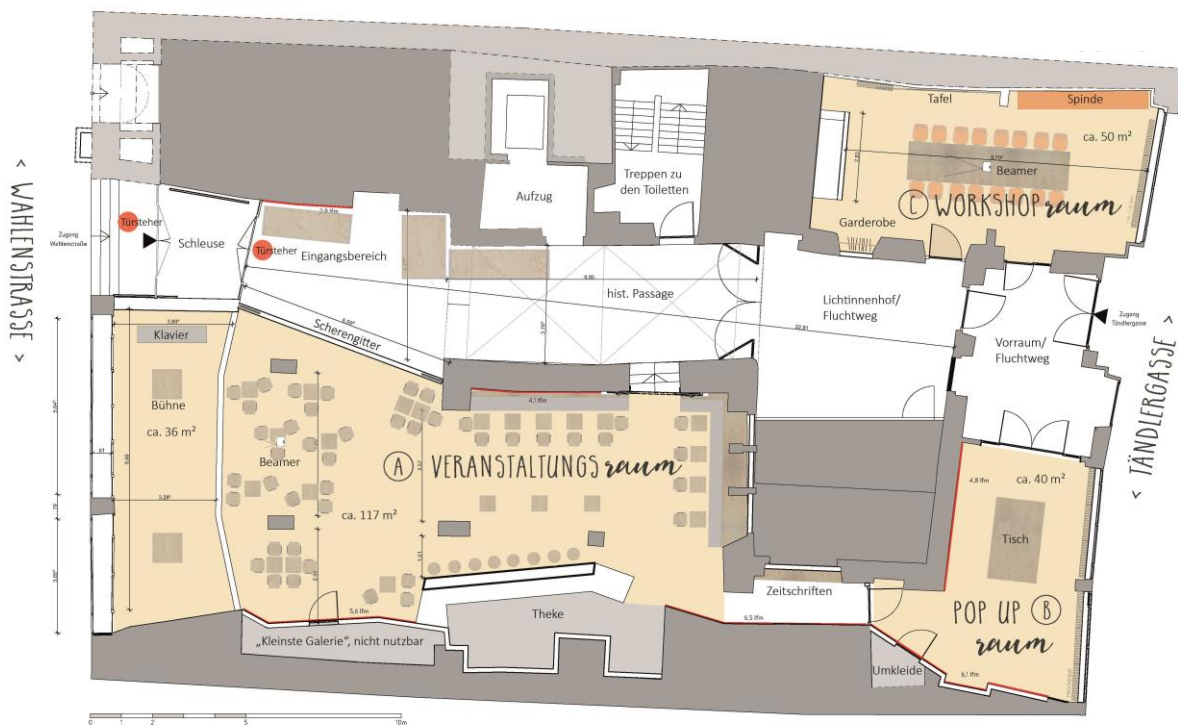

**TECHNOLOGY**

**Beamer**

- Vivitek Projector DH91x series
- Remote control beamer
- fixed projection screen 1,60m x 2,80m

**Cable**

- 1 x HDMI: 4K/ultra HD + 3D capable + Ethernet connectivity, 5m
- 1 x Adapter Mini Displayport to HDMI
- 1 x Schuko cable drum

**Speaker**

- JBL Control 2 PS, 2-way small speakers (connection via VGA > audio output)

**NO laptop / player / sound system** (must be brought by the organizer!)

## **ASSEMBLY INSTRUCTIONS**

### **Beamer**

Switch on the beamer at the touch panel on the back of the projection screen.  
Please do not forget to switch off.

Laptop > HDMI cable (with adapter if necessary) > HDMI socket (bottom right of the projection screen)

### **Sound**

Switch on by plugging the black power cable into the wall on the right behind the projection screen.  
Please do not forget to switch off.

## **SEATING OPTIONS**

- Table board for 20 persons
- Row seating for 30 people

## **OTHER EQUIPMENT**

- Bavaria W-LAN free of charge / LAN on request
- Flipchart
- white board
- (magnetic) board incl. chalk
- Paper roll
- Daylight
- Blackout option
- Wardrobe in the room
- Lockers (can be used with own padlock by arrangement)

## **GASTRONOMY**

HTW GmbH has the exclusive right to serve the DEGGINGER.

Contact via [post@degginger-caffeebar.de](mailto:post@degginger-caffeebar.de) .

## **BASICS FROM THE USE AGREEMENT (excerpt etc.)**

- Recommendation: The number of persons is limited to 20-30 persons.
- Smoking on Tändlergasse is prohibited in the evening.
- The use of smoke and heat generating devices, e.g. fog machines, is prohibited in the DEGGINGER.
- The user has to take care of sufficient liability insurance protection.
- No third-party property can be stored in DEGGINGER before or after events.
- The premises must be left clean.
- Disposal of waste especially packaging material, cardboard boxes is excluded in DEGGINGER.
- Exhibits can be attached to the maritime pine wall by nailing and gluing.
- Exhibits can only be attached to the historical stone walls by gluing. Attention: Adhesive tapes do not hold well on the wall.
- Exhibits may only be attached to the historical stone walls by nailing in individual cases and after consultation. Nails may not be driven in deeper than 0.5 cm in order not to endanger the historical building fabric.
- The walls may only be painted with silicate paint.